

Molteni & C

QUINTEN — VINCENT VAN DUYSSEN 2016

1—
3



Quinten: perfectly proportioned sideboards, an attentive choice of materials and treatments such as matt laquered, woods and, in the new finishes, copper or pewter colour, as well as attention to the individual details ensure that every single item of furniture is a piece of refined beauty, where lines and volumes blend harmoniously.

DATASHEET

REGISTERED
DESIGN

IX.2023

moltenigroup.com

Dimensions in centimeters and inches. The right to discontinue and make changes is reserved. This information is based on the latest product information available at the time of printing.

FINISHES

NOTES

- ▶ The compartment with doors always has a finish in matt lacquer in the same colour as the doors and includes an internal shelf.
- ▶ Extractable trays can be accessorised with Eco Skin tray bottoms.
- ▶ Cupboards can be fitted with a spotlight under the top to light the open compartment. To indicate when ordering because it is recessed into the top.

BASE, SIDES, BACKS AND TRAY DIVIDERS FINISHES

pewter colour paint
copper paint

TRAYS AND TOPS FINISHES

eucalyptus
graphite oak

INTERNAL SHELF FINISHES

matt lacquer colours in the Molteni colour range •

- **excluding pewter colour and copper**

DOOR FINISHES

matt lacquer colours in the Molteni colour range •
pewter colour paint
copper paint

ECO SKIN BOTTOMS FOR TRAYS

grey
mink
hemp
ivory
dark brown
earth
arctic
taupe

2—
3

TECHNICAL INFORMATION

EXTERNAL COVERS, DOORS, SHELF AND INTERNAL PARTS

Chipboard panel covered in melamine facing painted in Molteni range colours.

TOP TALL CUPBOARDS, TRAYS

Chipboard panel covered in veneer of Eucalyptus (*Eucalyptus globulus*) or Oak (*Quercus*).

STRUCTURAL BASE

In painted steel.

BRONZE MIRROR

Silver bronze glass, 4 mm thick.

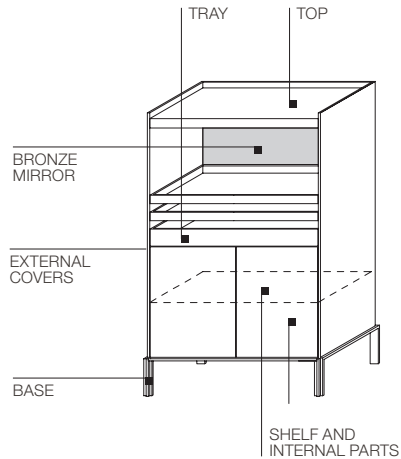

DATASHEET

REGISTERED
DESIGN

IX.2023

DIMENSIONS

* pull-out tray

** pull-out trays that
can be accessorised
with dividers

cupboards

W 94 D 50 H 150
W 37" D 19 5/8" H 59"

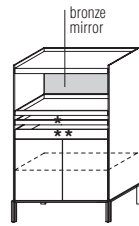

with base H 20
MQ15/94

W 122 D 50 H 150
W 48" D 19 5/8" H 59"

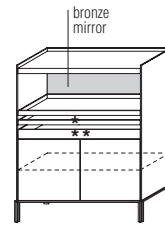

with base H 20
MQ15/12

Molteni & C

3—
3

**additional bottom
in Eco Skin for
pull-out trays * ****

W 85,9 D 43,6
W 39 3/4" D 17 1/8"



CEQ15/94

W 113,9 D 43,6
W 44 7/8" D 17 1/8"



CEQ15/12

**dividers for
pull-out trays ****
H 8,4 - 3 1/4"

W 85,9 D 35,8
W 39 3/4" D 14 1/8"

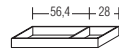

CDI15/94A

W 113,9 D 35,8
W 44 7/8" D 14 1/8"

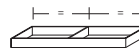

CDI15/12A

**USB or magnetic
rechargeable spotlight**



EF1

DATASHEET

REGISTERED
DESIGN

IX.2023